

**RIVERWOODS NORTH - LONG-TERM CARE FACILITY,
LEWISBURG, PENNSYLVANIA**

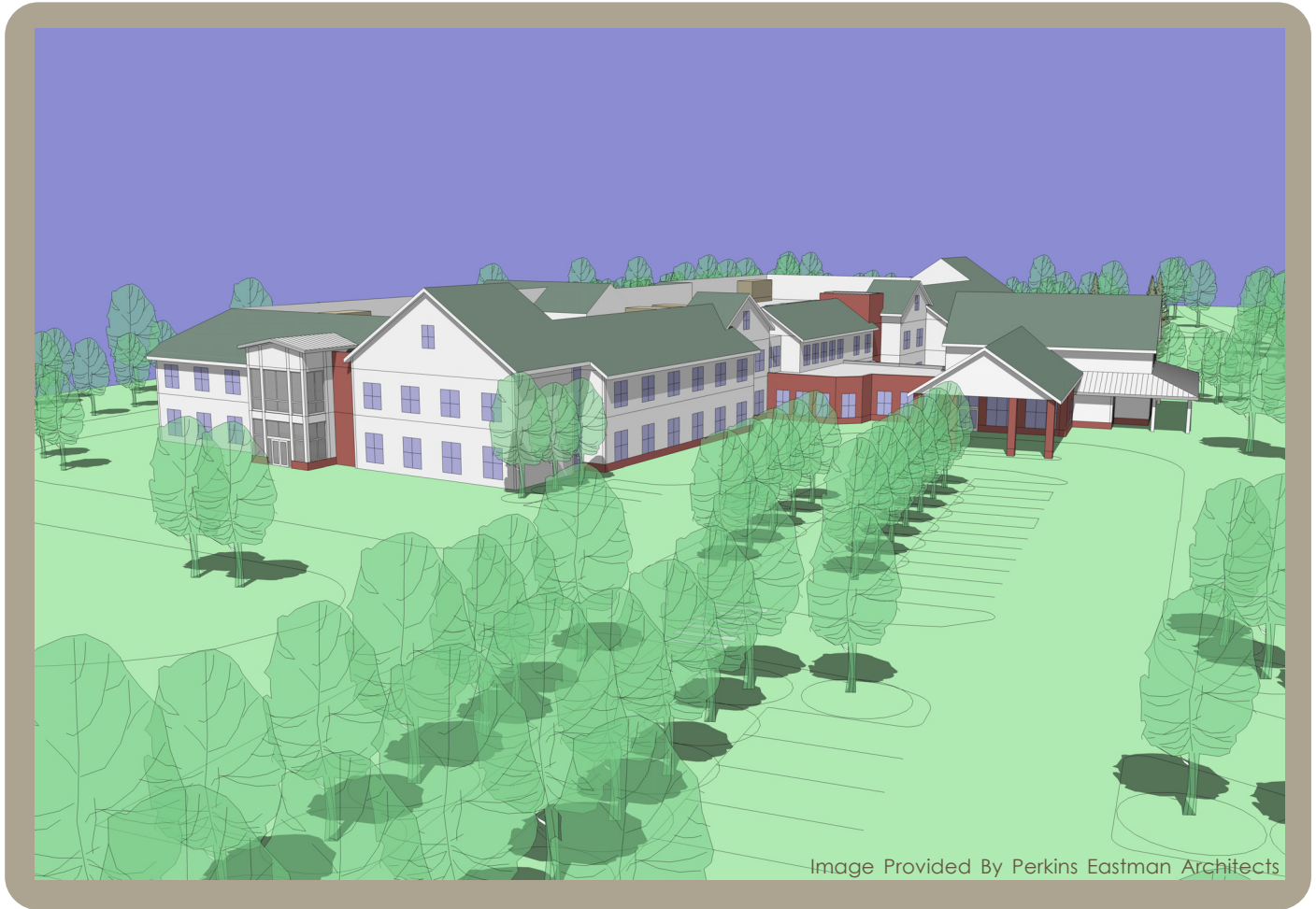

Image Provided By Perkins Eastman Architects



The project consists of the replacement of an existing long-term care facility with a new 2-story, 128-bed facility that is structured around 8 households. Each household includes private and semiprivate resident rooms, living room with an electric fire place, dining room and other support areas. Every two households are organized into a neighborhood that includes a kitchen, private dining room, and a screened porch. Each resident room includes a bathroom with a roll-in shower. The design provides a residential environment and minimizes travel distance for residents and staff.

The facility includes a meeting hall, porte cochere, administration and support offices, loading dock, locker rooms, laundry and commercial kitchen with employee dining room. The facility is designed to emulate the agrarian residence of the surrounding communities and for energy efficiency. The site is an expansion of the existing continuing care retirement community campus with new access roads, public and staff parking, and a tree lined pedestrian path to the other facilities on the campus.

HAAS Building Solutions designed the project in association with Perkins Eastman Architects.

Owner:

Albright Care Services

Key Project Staff:

Dallas L. Miller, AIA, LEED AP,

Chad M. Maholtz,

David Connolly, PE,

Josh Kendle, Assoc. AIA,

Jacob Beury

Completion Date:

Est. 2012

Construction Cost:

\$22,500,000

Gross Floor Area:

115,000 Sq. Ft.

Contact Person:

Albright Care Services

Lewisburg, Pennsylvania

(570) 522-3880